

INSTALLATION AND SERVICE MANUAL



For installation of Gini wall surface luminaire.
Model. UGN-30021 and UGN-30031.

Product drawing (dimensions)

SUITABLE FOR WET LOCATIONS

UGN-30021

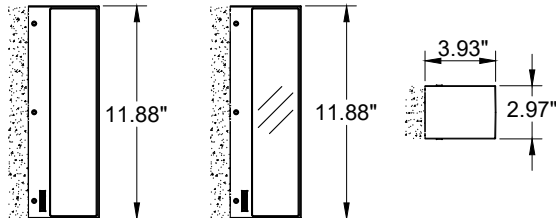

Top view

Bottom view

Side view

UGN-30031

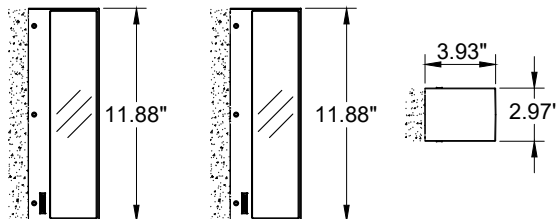

Top view

Bottom view

Side view

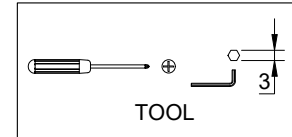

TOOL

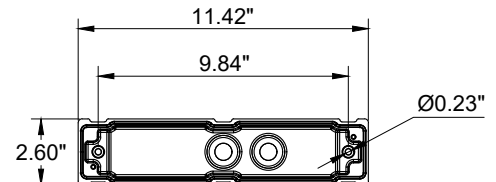

MOUNTING DETAIL

NOTE Mounts over
a 3" Octagonal
Junction box.

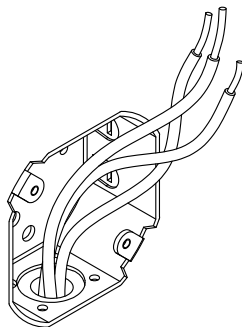

1

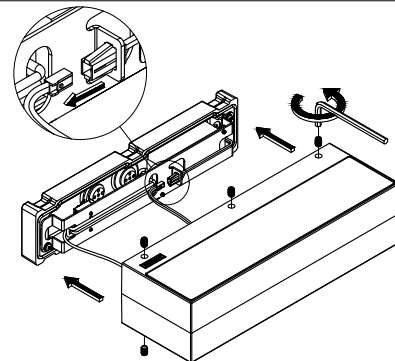

2

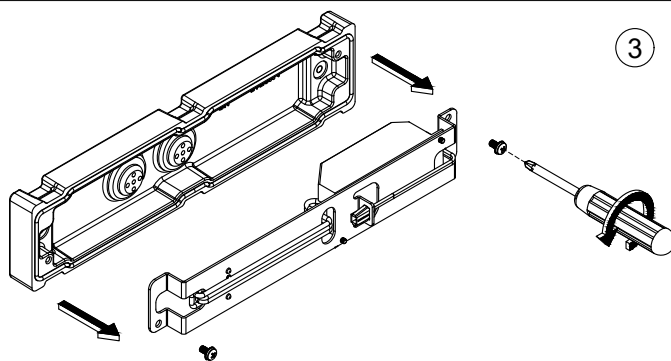

3

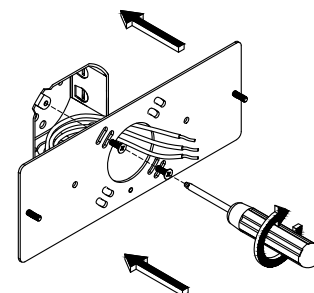

4

Position the body over the J Box and
Secure the back plate to the wall

Notice to installer :

- 1.WIRING INSTRUCTIONS** Warning : RISK OF FIRE AND ELECTRICAL SHOCK. : FIXTURE MUST BE INSTALLED BY A QUALIFIED ELECTRICIAN ONLY>FIXTURE IS INTENDED FOR INSTALLATION IN ACCORDANCE WITH THE NATIONAL ELECTRICAL CODE, LOCAL AND FEDERAL CODE SPECIFICATIONS. DISCONNECT POWER BEFORE SERVICING.
- 2.This fixture has a VOLTAGE SPECIFIC BALLAST,**Check that the supply voltage is the same as the installed ballast voltage.

Ligman Lighting USA

7144 NE Progress Court, Hillsboro
Oregon, 97124, USA
Tel : 503 645 0500 | Fax : 503 645 8100

www.ligmanlightingusa.com

FM-TS-13-1/13-05-2563/Rev.6

